

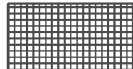



316 ATHLETIC FIELD IMPROVEMENTS: REF NOTES SCHEDULE

SYMBOL	IRRIGATION DESCRIPTION	QTY	DETAIL
	32-91-04A VEGETATION AND ROOTZONE REMOVAL	70,173 sf	1/L1.01
	32-91-04B DRAINAGE CHANNELS	70,173 sf	2/L1.01

GENERAL NOTES

- THE STATE OF CONNECTICUT STANDARD SPECIFICATIONS FOR HIGHWAYS AND BRIDGE, OR LATEST REVISION, THE CONNECTICUT STANDARD DETAILS AND THE TOWN OF HEBRON ARE MADE A PART HEREOF AS FULLY AND COMPLETELY AS IF ATTACHED HERETO.
- THE EXISTING BUILDING WILL REMAIN OPEN AND OPERATIONAL DURING CONSTRUCTION.
- THE CONTRACTOR SHALL MAKE ALL NECESSARY CONSTRUCTION NOTIFICATIONS AND APPLY FOR AND OBTAIN ALL NECESSARY CONSTRUCTION PERMITS, PAY ALL FEES AND POST ALL BONDS ASSOCIATED WITH THE SAME, AND COORDINATE WITH THE OWNER AND THE ENGINEER.
- THE CONTRACTOR SHALL BE SOLELY RESPONSIBLE FOR JOB SITE SAFETY. THE CONTRACTOR SHALL PROVIDE TEMPORARY FENCING AND/OR BARRIERS AROUND ALL OPEN EXCAVATED AREAS, AND CONDUCT ALL WORK IN ACCORDANCE WITH OSHA STANDARDS AND THE TOWN OF RAYNHAM REQUIREMENTS.
- IF ANY DEVIATION OR ALTERATION OF THE WORK PROPOSED ON THESE DRAWINGS IS REQUIRED, THE CONTRACTOR IS TO IMMEDIATELY CONTACT AND COORDINATE WITH THE ENGINEER AND OWNER.
- ANY AREA OUTSIDE OF THE LIMIT OF WORK THAT IS DISTURBED SHALL BE RESTORED TO ITS ORIGINAL CONDITION AT NO COST TO THE OWNER.
- ALL EXISTING CONDITIONS SHOWN SHALL BE CONSIDERED APPROXIMATE AND ARE BASED ON THE BEST INFORMATION AVAILABLE. THE CONTRACTOR SHALL BE RESPONSIBLE FOR VERIFYING THAT THE PROPOSED IMPROVEMENTS SHOWN ON THE PLANS DO NOT CONFLICT WITH ANY KNOWN EXISTING OR OTHER PROPOSED IMPROVEMENTS. IF ANY CONFLICTS ARE DISCOVERED, THE CONTRACTOR SHALL NOTIFY THE OWNER AND THE ENGINEER PRIOR TO INSTALLATION OF ANY PORTION OF THE SITE WORK WHICH WOULD BE AFFECTED.
- ALL UTILITIES (LOCATION AND ELEVATION) SHOWN SHALL BE CONSIDERED APPROXIMATE ONLY. BEFORE COMMENCING SITE WORK IN ANY AREA, CONTACT "DIG SAFE" AT 1-888-344-7233 AND ALL UTILITY COMPANIES NOT COVERED BY "DIG SAFE". TO ACCURATELY LOCATE UNDERGROUND UTILITIES. ANY DAMAGE TO EXISTING UTILITIES OR STRUCTURES AS SHOWN ON THE PLANS SHALL BE THE CONTRACTOR'S RESPONSIBILITY. COSTS OF SUCH DAMAGE SHALL BE THE CONTRACTOR'S RESPONSIBILITY. NO EXCAVATION SHALL BE DONE UNTIL COMPANIES ARE PROPERLY NOTIFIED IN ADVANCE. NOTE THAT NOT ALL EXISTING UNDERGROUND UTILITIES ARE SHOWN. IT IS THE CONTRACTOR'S RESPONSIBILITY TO CONTACT ALL RESPECTIVE UTILITY COMPANIES TO VERIFY AND LOCATE EXISTING UTILITIES.
- ALL WORK WITHIN THE RIGHT OF WAY SHALL CONFORM TO THE TOWN OF HEBRON DEPARTMENT OF PUBLIC WORKS REQUIREMENTS, AND MASSACHUSETTS STANDARD SPECIFICATIONS FOR HIGHWAYS AND BRIDGES 1995 EDITION AND THE 2002 EDITION OF THE SUPPLEMENTAL SPECIFICATIONS, OR LATEST REVISIONS TO BOTH.

DEMOLITION NOTES

- ALL DEMOLITION SHALL BE COORDINATED WITH THE OWNER PRIOR TO START OF WORK.
- PAVEMENT DEMOLITION SHALL BE SAW CUT AND DISPOSED OF PROPERLY.
- UNDERGROUND UTILITIES WERE COMPILED FROM AVAILABLE RECORD PLANS OF UTILITY COMPANIES AND PUBLIC AGENCIES AND ARE APPROXIMATE AND ASSUMED. BEFORE COMMENCING SITE WORK IN ANY AREA, CONTACT "DIG SAFE" AT 1-888-DIG-SAFE AND ALL UTILITY COMPANIES NOT COVERED BY "DIG SAFE" TO ACCURATELY LOCATE UNDERGROUND UTILITIES. ANY DAMAGE TO EXISTING UTILITIES OR STRUCTURES AS SHOWN ON THE PLANS SHALL BE THE CONTRACTOR'S RESPONSIBILITY. COSTS OF SUCH DAMAGE SHALL BE THE CONTRACTOR'S RESPONSIBILITY. NO EXCAVATION SHALL BE DONE UNTIL UTILITY COMPANIES ARE PROPERLY NOTIFIED.
- THE CONTRACTOR SHALL COORDINATE ALL DEMOLITION OF STRUCTURES, PAVEMENT AND CONCRETE MATERIALS, AND UTILITIES WITH APPROPRIATE PROPOSED SITE GENERAL AND UTILITY DRAWINGS.
- THE CONTRACTOR SHALL REMOVE ALL UNSUITABLE SOILS TO THE LIMITS SATISFACTORY TO THE ENGINEER.

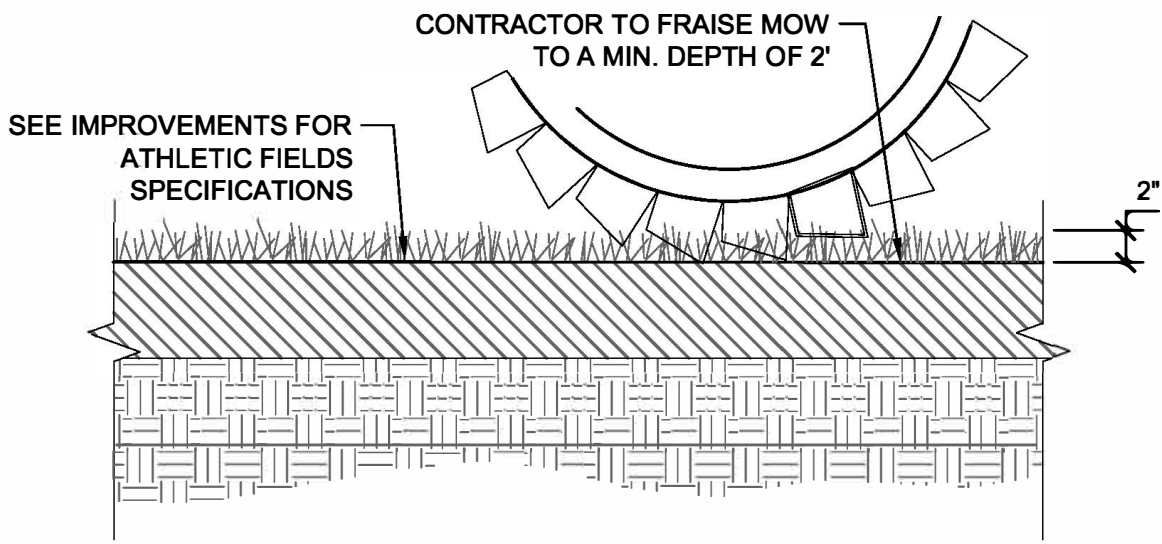

- NOTES:
- SEE PLANS FOR LIMITS OF FRAISE MOWING AREA.
  - AREAS OUTSIDE THE LIMITS OF PROPOSED WORK DISTURBED BY THE CONTRACTOR'S OPERATIONS SHALL BE RESTORED BY THE CONTRACTOR WITH 6 INCHES LOAM AND SEED.
  - AREAS DISTURBED DURING CONSTRUCTION AND NOT RESTORED WITH IMPERVIOUS SURFACES (BUILDINGS, PAVEMENTS, WALKS, ETC.) SHALL RECEIVE 6 INCHES LOAM AND SEED/SOD.

1 VEGETATION AND ROOTZONE REMOVAL  
1" = 1'-0"

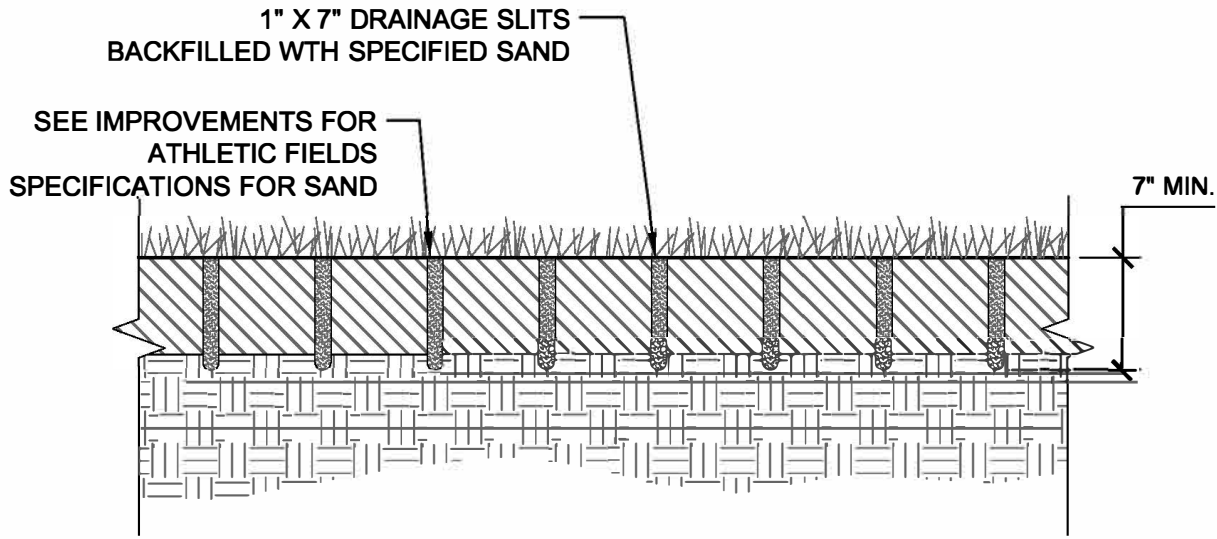

- NOTES:
- SEE PLANS FOR LIMITS OF DRAINAGE CHANNELS AREA.
  - AREAS OUTSIDE THE LIMITS OF PROPOSED WORK DISTURBED BY THE CONTRACTOR'S OPERATIONS SHALL BE RESTORED BY THE CONTRACTOR WITH 6 INCHES LOAM AND SEED.
  - AREAS DISTURBED DURING CONSTRUCTION AND NOT RESTORED WITH IMPERVIOUS SURFACES (BUILDINGS, PAVEMENTS, WALKS, ETC.) SHALL RECEIVE 6 INCHES LOAM AND SEED/SOD.

2 DRAINAGE CHANNELS  
1" = 1'-0"

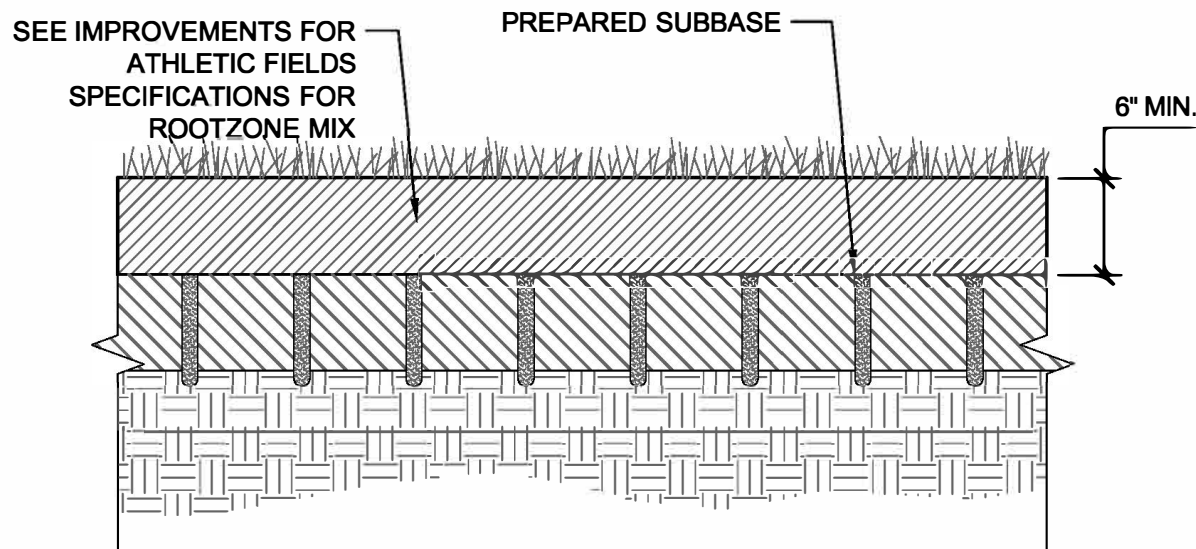

- NOTES:
- SEE PLANS FOR LIMITS OF ROOTZONE MIX.
  - CONTRACTOR TO FINE GRADE THE FIELD TO MATCH THE SUBBASE OF THE FIELD.
  - CONTRACTOR TO ADJUST EXISTING IRRIGATION HEADS TO MATCH NEW FINISHED GRADE.
  - CONTRACTOR TO SEED, FERTILIZE, AND WATER AS OUTLINED IN THE IMPROVEMENTS FOR ATHLETIC FIELDS SPECIFICATION.

3 ROOTZONE MIX  
1" = 1'-0"

STAMP



PROJECT NAME

RHAM HIGH SCHOOL  
ATHLETIC  
IMPROVEMENTS

PROJECT ADDRESS

85 WALL STREET  
HEBRON, CT 06248

NO.	REVISIONS	DATE
△		
△		
△		
△		
△		
△		

SUBMITTAL	DATE

DRAWN BY: AE	CHECKED BY: AE
DATE ISSUED: MAY, 2003	SCALE: 1"=40'-0"

PROJ. NO.  
A1056

SHEET TITLE

316 FIELD  
ATHLETIC  
IMPROVEMENTS

SHEET NO.

L1.01

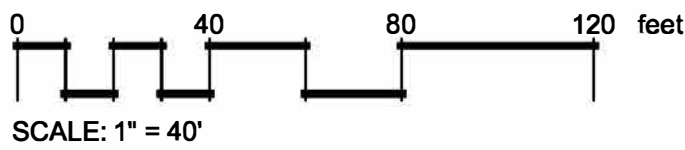



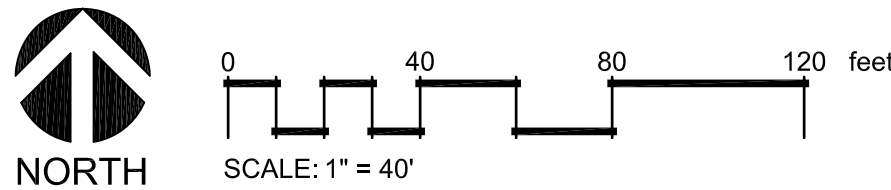

NOTE:

1. CONTRACTOR TO PROVIDE SHOP DRAWING INCLUDING LAYOUT, GRADING AND CONNECTIONS FOR TRENCH DRAIN.
2. CONTRACTOR TO PROVIDE TRACK CROSSING PROTECTION PLAN
3. ALL PROPOSED DRAINAGE TO BE CONNECTED TO EXISTING DRAINAQGE.
4. CONTRACTOR TO PROVIDE INLET PROTECTION ON ALL EXISTING DRAINAGE STRUCTURES.

## COMP ATHLETIC FIELD IMRPOVEMENTS: REF NOTES SCHEDULE

SYMBOL	STORM DRAINAGE UTILITIES DESCRIPTION	QTY	DETAIL
33-40-00A	TRENCH DRAIN	3,876 lf	2/L1.02
33-40-00B	6" HDPE PERFORATED COLLECTOR DRAIN	1,278 lf	3/L1.02

### GENERAL NOTES

1. THE STATE OF CONNECTICUT STANDARD SPECIFICATIONS FOR HIGHWAYS AND BRIDGE, OR LATEST REVISION, THE CONNECTICUT STANDARD DETAILS AND THE TOWN OF HEBRON ARE MADE A PART HEREOF AS FULLY AND COMPLETELY AS IF ATTACHED HERETO.
2. THE EXISTING BUILDING WILL REMAIN OPEN AND OPERATIONAL DURING CONSTRUCTION.
3. THE CONTRACTOR SHALL MAKE ALL NECESSARY CONSTRUCTION NOTIFICATIONS AND APPLY FOR AND OBTAIN ALL NECESSARY CONSTRUCTION PERMITS, PAY ALL FEES AND POST ALL BONDS ASSOCIATED WITH THE SAME, AND COORDINATE WITH THE OWNER AND THE ENGINEER.
4. THE CONTRACTOR SHALL BE SOLELY RESPONSIBLE FOR JOB SITE SAFETY. THE CONTRACTOR SHALL PROVIDE TEMPORARY FENCING AND/OR BARRIERS AROUND ALL OPEN EXCAVATED AREAS, AND CONDUCT ALL WORK IN ACCORDANCE WITH OSHA STANDARDS AND THE TOWN OF RAYNHAM REQUIREMENTS.
5. IF ANY DEVIATION OR ALTERATION OF THE WORK PROPOSED ON THESE DRAWINGS IS REQUIRED, THE CONTRACTOR IS TO IMMEDIATELY CONTACT AND COORDINATE WITH THE ENGINEER AND OWNER.
6. ANY AREA OUTSIDE OF THE LIMIT OF WORK THAT IS DISTURBED SHALL BE RESTORED TO ITS ORIGINAL CONDITION AT NO COST TO THE OWNER.
7. ALL EXISTING CONDITIONS SHOWN SHALL BE CONSIDERED APPROXIMATE AND ARE BASED ON THE BEST INFORMATION AVAILABLE. THE CONTRACTOR SHALL BE RESPONSIBLE FOR VERIFYING THAT THE PROPOSED IMPROVEMENTS SHOWN ON THE PLANS DO NOT CONFLICT WITH ANY KNOWN EXISTING OR OTHER PROPOSED IMPROVEMENTS. IF ANY CONFLICTS ARE DISCOVERED, THE CONTRACTOR SHALL NOTIFY THE OWNER AND THE ENGINEER PRIOR TO INSTALLATION OF ANY PORTION OF THE SITE WORK WHICH WOULD BE AFFECTED.
8. ALL UTILITIES (LOCATION AND ELEVATION) SHOWN SHALL BE CONSIDERED APPROXIMATE ONLY. BEFORE COMMENCING SITE WORK IN ANY AREA, CONTACT "DIG SAFE" AT 1-888-344-7233 AND ALL UTILITY COMPANIES NOT COVERED BY "DIG SAFE", TO ACCURATELY LOCATE UNDERGROUND UTILITIES. ANY DAMAGE TO EXISTING UTILITIES OR STRUCTURES AS SHOWN ON THE PLANS SHALL BE THE CONTRACTOR'S RESPONSIBILITY. COSTS OF SUCH DAMAGE SHALL BE THE CONTRACTOR'S RESPONSIBILITY. NO EXCAVATION SHALL BE DONE UNTIL COMPANIES ARE PROPERLY NOTIFIED IN ADVANCE. NOTE THAT NOT ALL EXISTING UNDERGROUND UTILITIES ARE SHOWN. IT IS THE CONTRACTORS RESPONSIBILITY TO CONTACT ALL RESPECTIVE UTILITY COMPANIES TO VERIFY AND LOCATE EXISTING UTILITIES.
9. ALL WORK WITHIN THE RIGHT OF WAY SHALL CONFORM TO THE TOWN OF HEBRON DEPARTMENT OF PUBLIC WORKS REQUIREMENTS, AND MASSACHUSETTS STANDARD SPECIFICATIONS FOR HIGHWAYS AND BRIDGES 1995 EDITION AND THE 2002 EDITION OF THE SUPPLEMENTAL SPECIFICATIONS, OR LATEST REVISIONS TO BOTH.

### DEMOLITION NOTES

1. ALL DEMOLITION SHALL BE COORDINATED WITH THE OWNER PRIOR TO START OF WORK.
2. PAVEMENT DEMOLITION SHALL BE SAW CUT AND DISPOSED OF PROPERLY.
3. UNDERGROUND UTILITIES WERE COMPILED FROM AVAILABLE RECORD PLANS OF UTILITY COMPANIES AND PUBLIC AGENCIES AND ARE APPROXIMATE AND ASSUMED. BEFORE COMMENCING SITE WORK IN ANY AREA, CONTACT "DIG SAFE" AT 1-888-DIG-SAFE AND ALL UTILITY COMPANIES NOT COVERED BY "DIG SAFE" TO ACCURATELY LOCATE UNDERGROUND UTILITIES. ANY DAMAGE TO EXISTING UTILITIES OR STRUCTURES AS SHOWN ON THE PLANS SHALL BE THE CONTRACTOR'S RESPONSIBILITY. COSTS OF SUCH DAMAGE SHALL BE THE CONTRACTOR'S RESPONSIBILITY. NO EXCAVATION SHALL BE DONE UNTIL UTILITY COMPANIES ARE PROPERLY NOTIFIED.
4. THE CONTRACTOR SHALL COORDINATE ALL DEMOLITION OF STRUCTURES, PAVEMENT AND CONCRETE MATERIALS, AND UTILITIES WITH APPROPRIATE PROPOSED SITE GENERAL AND UTILITY DRAWINGS.
5. THE CONTRACTOR SHALL REMOVE ALL UNSUITABLE SOILS TO THE LIMITS SATISFACTORY TO THE ENGINEER.

### EROSION AND SEDIMENTATION CONTROL NOTES

1. DUST SHALL BE CONTROLLED BY WATERING OR OTHER APPROVED METHODS AS NECESSARY, OR AS DIRECTED BY THE OWNER OR ENGINEER.
2. THE CONTRACTOR SHALL SCHEDULE HIS/HER WORK TO ALLOW THE FINISHED SUB GRADE ELEVATIONS TO DRAIN PROPERLY WITHOUT PONDING. SPECIFICALLY, ALLOW WATER TO ESCAPE WHERE PROPOSED CURB MAY RETAIN RUNOFF PRIOR TO APPLICATION OF SURFACE PAVING. PROVIDE TEMPORARY POSITIVE DRAINAGE, AS REQUIRED, TO STABILIZED DISCHARGE POINTS. CONTRACTOR IS RESPONSIBLE FOR ALL TEMPORARY UTILITY CONNECTIONS.
3. THE CONTRACTOR SHALL MAINTAIN A SUFFICIENT RESERVE OF VARIOUS EROSION CONTROL MATERIALS ONSITE AT ALL TIMES FOR EMERGENCY PURPOSES.
4. ANY DEWATERING WASTE WATERS PUMPED FROM EXCAVATIONS SHALL BE CONVEYED BY HOSE TO AN UPLAND AREA AND DISCHAP
5. CONSTRUCTION SITE WASTE MATERIALS SHALL BE PROPERLY CONTAINED ONSITE AND DISPOSED OFF SITE IN ACCORDANCE WITH ALL APPLICABLE LOCAL AND STATE REGULATIONS.
6. ALL DISTURBED AREAS SHALL BE STABILIZED WITHIN 14 DAYS OF COMPLETION OF WORK IN THAT AREA.
7. ALL DRAINAGE STRUCTURES SHALL BE CLEARED OF ACCUMULATED SEDIMENT PRIOR TO ACCEPTANCE OF FINAL PROJECT.
8. THE CONTRACTOR SHALL MAINTAIN SURFACE DRAINAGE DURING CONSTRUCTION. STORMWATER SHALL BE MAINTAINED AWAY FROM WORK SITES WHILE PREVENTING AREAS OF EROSION.
9. CONTRACTOR IS RESPONSIBLE FOR INSTALLING AND MAINTAINING NECESSARY TEMPORARY EROSION CONTROL MEASURES.
10. THE CONTRACTOR SHALL BE RESPONSIBLE FOR ESTABLISHING OR INSTALLING ALL TEMPORARY SEDIMENT AND EROSION CONTROLS AS SHOWN ON THESE PLANS AND SHALL MAINTAIN ALL EROSION CONTROL MEASURES AS NECESSARY DURING THE ENTIRE CONSTRUCTION PERIOD.
11. TEMPORARY DIVERSION SWALES SHALL BE PROVIDED AS NECESSARY TO DIRECT RUNOFF TO THE SEDIMENT BASINS DURING CONSTRUCTION.
12. ANTI-TRACKING PADS AND WHEEL WASH STATIONS SHALL BE PROVIDED AT ALL POINTS OF EGRESS OR INGRESS AND SHALL BE MAINTAINED TO LIMIT TRACKING OR FLOWING OF SEDIMENT ONTO PUBLIC ROADS AND INTO THE REST OF THE SITE.
13. EROSION CONTROL BARRIERS SHALL BE INSTALLED AS SHOWN ON THE EROSION CONTROL PLAN PRIOR TO COMMENCEMENT OF CONSTRUCTION OPERATIONS.
14. SOIL EROSION AND SEDIMENTATION CONTROL MEASURES SHALL BE INSPECTED AND MAINTAINED ON A WEEKLY BASIS AND AFTER EACH STORM EVENT OF 0.25 INCH OR GREATER DURING CONSTRUCTION TO INSURE THAT CHANNELS, DITCHES AND PIPES ARE CLEAR OF DEBRIS AND THAT THE EROSION CONTROL BARRIERS ARE INTACT. IDENTIFIED DEFICIENCIES SHALL BE CORRECTED IMMEDIATELY.
15. THE CONTRACTOR SHALL CLEAN AND MAINTAIN EROSION CONTROL BARRIER WHEN SEDIMENT ACCUMULATES TO ONE HALF THE HEIGHT OF THE HAYBALES OR ONE THIRD THE HEIGHT OF SILT FENCE. MATERIAL COLLECTED FROM THE SILTATION BARRIERS SHALL BE REMOVED AS NECESSARY AND DISPOSED IN AN UPLAND AREA.
16. INSTALLATION OF THE EROSION CONTROL BARRIERS AS ILLUSTRATED IS INTENDED TO REPRESENT THE MINIMUM SEDIMENTATION CONTROL FACILITIES NECESSARY TO MEET ANTICIPATED SITE CONDITIONS. ADDITIONAL EROSION CONTROL MEASURES SHALL BE IMPLEMENTED AS CONDITIONS WARRANT OR AS DIRECTED BY THE OWNER OR OWNER'S REPRESENTATIVE.
17. REQUIRED SEDIMENTATION CONTROL FACILITIES MUST BE PROPERLY ESTABLISHED, CLEARLY VISIBLE AND IN OPERATION PRIOR TO INITIATING ANY LAND CLEARING ACTIVITY AND/OR OTHER CONSTRUCTION RELATED WORK. SUCH FACILITIES SHALL REPRESENT THE LIMIT OF WORK. WORKERS SHALL BE INFORMED THAT NO CONSTRUCTION ACTIVITY IS TO OCCUR BEYOND THE LIMIT OF WORK AT ANY TIME THROUGHOUT THE CONSTRUCTION PERIOD.
18. CATCH BASINS AND STORM DRAIN INLETS SHALL BE PROTECTED WITH INLET PROTECTION.
19. THE CONTRACTOR SHALL NOT REMOVE ANY HAY BALES, SILT FENCE OR OTHER EROSION CONTROLS UNTIL THE CONTRIBUTING DRAINAGE AREA HAS BEEN PERMANENTLY STABILIZED.
20. RIP-RAP OR OTHER ENERGY DISSIPATERS SHALL BE USED WHERE NECESSARY TO PREVENT SCOUR.

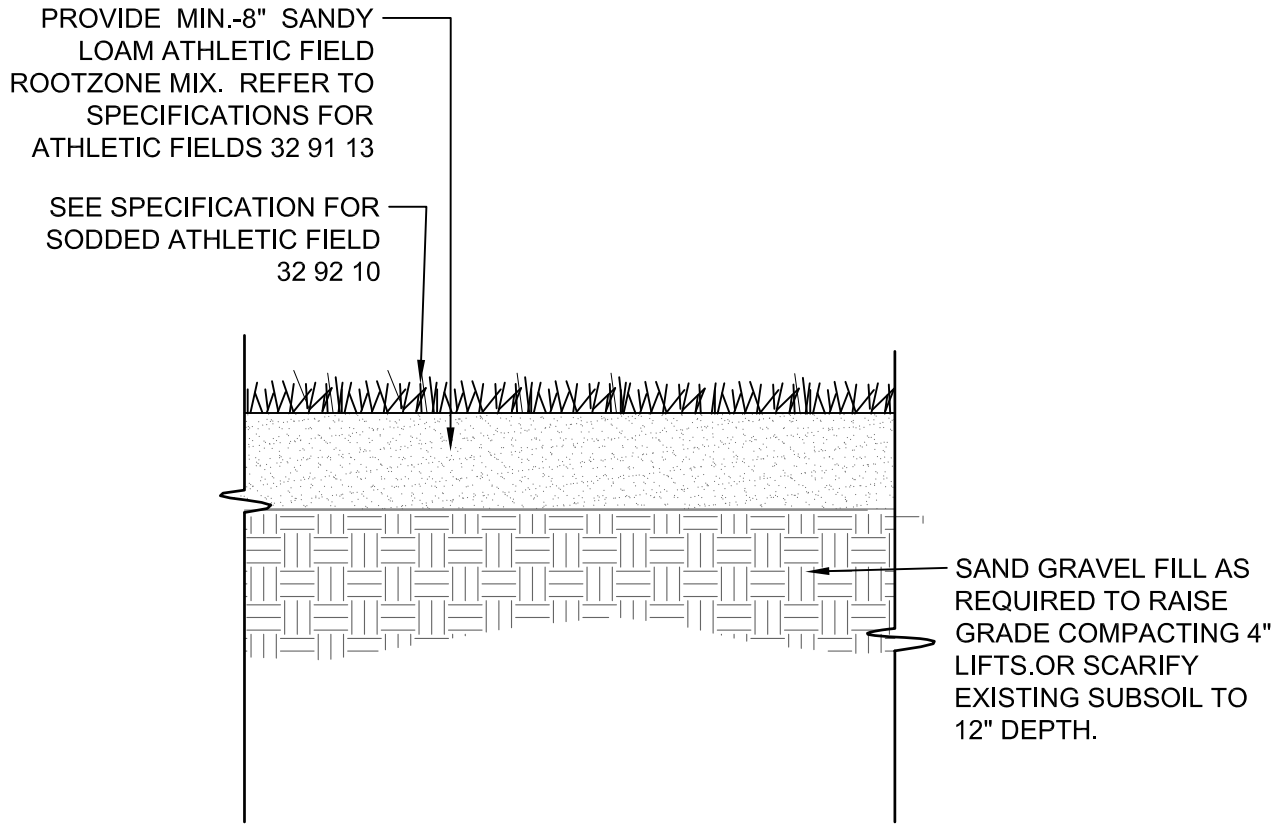

## 1 NATURAL GRASS ATHLETIC FIELD PROFILE

1" = 1'-0"

P-AT1-ARH-02

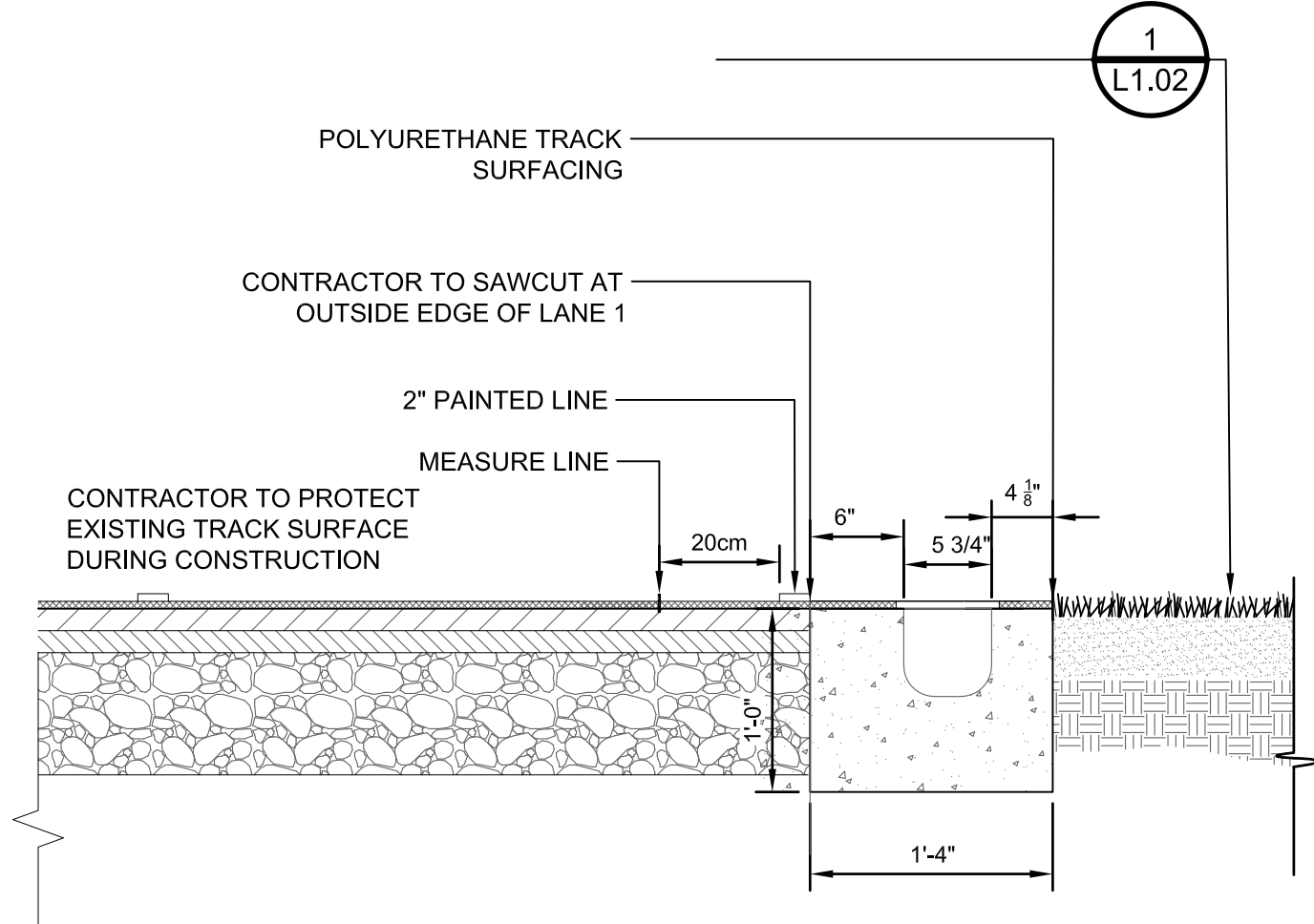

## 2 TRENCH DRAIN ADJACENT TO NATURAL TURF

1" = 1'-0"

P-AT1-ARH-03

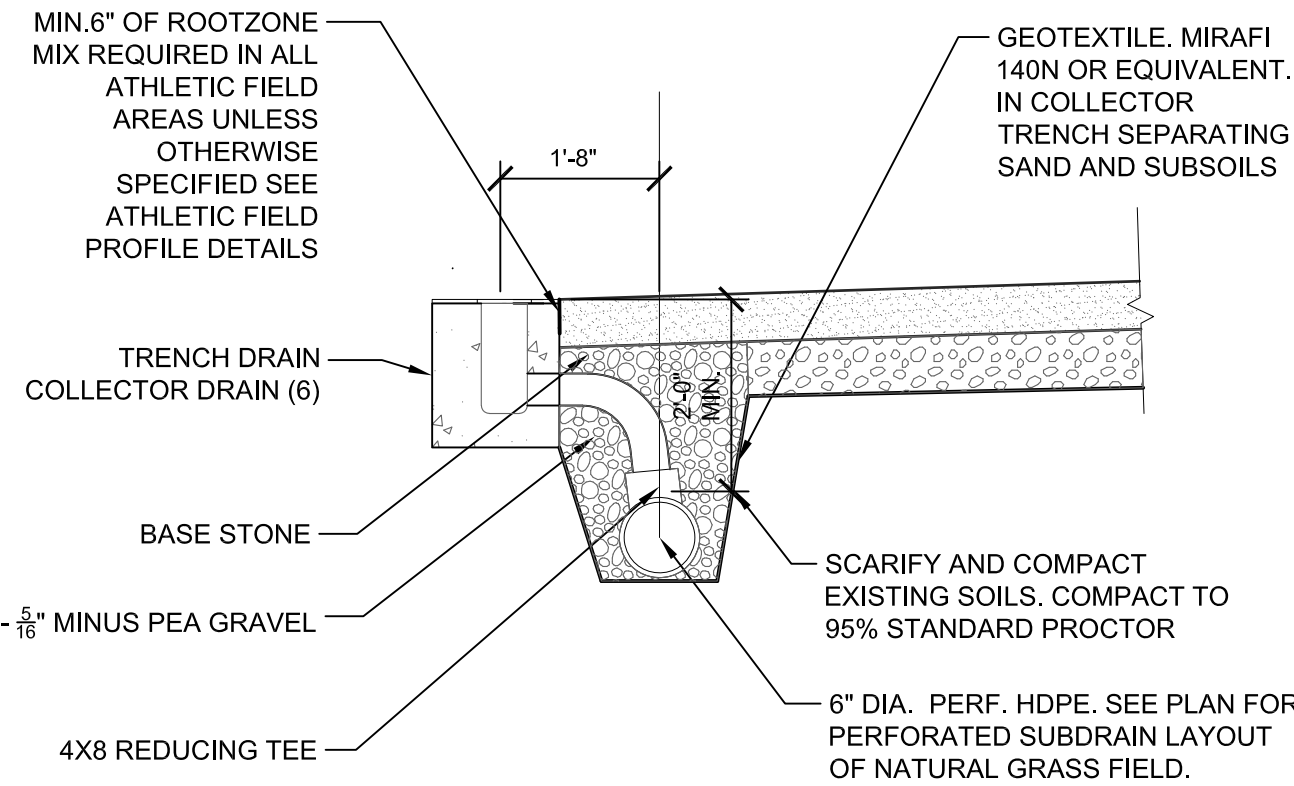

## 3 NATURAL GRASS ATHLETIC FIELD COLLECTOR DRAIN

1/2" = 1'-0"

STAMP



PROJECT NAME

**RHAM HIGH SCHOOL  
ATHLETIC  
IMPROVEMENTS**

PROJECT ADDRESS

85 WALL STREET  
HEBRON, CT 06248

NO.	REVISIONS	DATE
△		
△		
△		
△		
△		
△		

SUBMITTAL

DATE

DRAWN BY:  
AE

CHECKED BY:  
AE

DATE ISSUED:  
MAY, 2003

SCALE:  
1"=40'-0"

PROJ. NO.

A1056

SHEET TITLE

**COMP ATHLETIC  
IMPROVEMENTS**

SHEET NO.

**L1.02**